

A3

P1: 450mm SQUARE x 600mm DEEP MASS CONCRETE PAD FOOTING FOUNDED 100mm MIN INTO NATURAL SOIL OR CONTROLLED FILL. INCREASE PAD DEPTH IF/AS REQUIRED TO ACHIEVE THE ABOVE.

ALL FOOTING BEAMS ARE "B1" UNLESS NOTED OTHERWISE

WHERE BRITTLE FLOOR COVERINGS (eg TILED SURFACES) ARE TO BE USED OVER AN AREA GREATER THAN 16m2 FLEXIBLE ADHESIVE IS TO BE USED BETWEEN THE FLOOR COVERING AND SLAB. APPLY IN ACCORDANCE TO MANUFACTURERS SPECIFICATION TO ALLOW FOR POSSIBLE CONCRETE SHRINKAGE.

IMPORTANT NOTE:

BUILDER MUST ENSURE THAT AN ALLOWANCE FOR ANY SERVICE TRENCHES ON THE FOUNDING LEVEL OF THE FOOTINGS AND ANY STORMWATER SLEEVES THROUGH FOOTINGS ARE PROVIDED. BASE OF FOOTINGS MUST BE FOUNDED 100mm INTO NATURAL SOIL OR CONTROLLED FILL AND SUCH THAT A 45 DEGREE LINE DRAWN FROM THE BOTTOM OF THE PIER DOES NOT INTERSECT THE ADJOINING SERVICE TRENCH EXCAVATION. WHERE THIS CANNOT BE ACHIEVED, PLEASE PROVIDE 1200mm LONG x FOOTING WIDTH WIDE PIERS (AT FOOTING BEAM JUNCTIONS PARALLEL TO EXTERNAL FOOTINGS) TO ENSURE ABOVE CONDITION IS ACHIEVED. WHERE THE PIER DEPTH MEASURED FROM THE BOTTOM OF THE FOOTING EXCEEDS 400mm REINFORCE WITH 4/N12 VERTICAL BARS.

IMPORTANT NOTE:

THIS FOOTING DESIGN IS BASED ON ALL STORMWATER (INCLUDING SURFACE STORMWATER) BE REMOVED FROM AROUND THE DWELLING IN ACCORDANCE WITH ASS500.3, AS2870 AND THE BCA. WHERE GRAVITY FLOW OF STORMWATER IN ACCORDANCE WITH ASS500.3 CAN NOT BE ACHIEVED TO THE WATERABLE OR DOWN SLOPE ON AN ACRAGE SITE A SUMP PUMP WILL BE REQUIRED. RCI CONSULTING ENGINEERS WILL TAKE NO RESPONSIBILITY FOR FOOTING MOVEMENT RESULTING FROM STORMWATER DRAINAGE FAILURE TO COMPLY TO THE ABOVE.

NOTE:

ALL B2 FOOTINGS REQUIRED TO BE CONSTRUCTED ON BOUNDARY ARE TO BE FOUNDED A MINIMUM 600mm BELOW THE EXISTING ALLOTMENT GROUND LEVEL.

REFER PLAN FOR REINFORCEMENT. 20mm TOP COVER

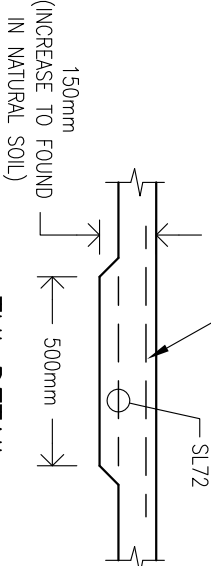

THI DETAIL NOT TO SCALE

FOOTING BEAMS

BEAM	WIDTH (mm)	DEPTH (mm)	REINFORCEMENT TOP SIZE No. BOTTOM SIZE No.	
B1	300	700	3 N16	3 N16
B2	350	700	3 N16	3 N16

BOREHOLE (REFER TO BORELOS)

DEPTH OF FILL FOUND IN BOREHOLE				
HOLE 1	0mm	HOLE 9	0mm	
HOLE 2	0mm	HOLE 10	0mm	
HOLE 3	0mm	HOLE 11	0mm	
HOLE 4	0mm	HOLE 12	0mm	
HOLE 5	0mm	HOLE 13	0mm	
HOLE 6	0mm	HOLE 14	0mm	
HOLE 7	0mm	HOLE 15	0mm	
HOLE 8	0mm			

LEGEND

3/N12 x 2000mm LONG CRACK CONTROL BARS TIED TO UNDERSIDE OF TOP MESH. STEP IN FOOTING BEAM, REFER TO FOOTING CONSTRUCTION REPORT FOR DETAILS.

1200mm LONG (MIN) x FOOTING WIDTH WIDE PIER, FOUND 100mm INTO NATURAL SOIL OR CONTROLLED FILL IF PRESENT (REFER TO BORELOS). REINFORCE WITH 4/N12 RODS VERTICAL WHERE DEPTH BELOW BASE OF FOOTING EXCEEDS 400mm. EXTENT OF PIERS TO BE CONFIRMED ON SITE.

SET DOWN IN RAFT SLAB REFER TO FOOTING CONSTRUCTION REPORT FOR DETAILS. ENSURE FOOTING DEPTHS ARE MAINTAINED BELOW SET DOWN.

125mm THICK SLAB WITH TWO LAYERS OF MESH. ONE LAYER PLACED WITH 20mm TOP COVER AND THE OTHER WITH 30mm BOTTOM COVER. REFER TO SLAB NOTES FOR MESH SIZE. AREA SHOWN HATCHED IS INDICATIVE ONLY AND IS TO BE CONFIRMED ON SITE.

FOOTING PLAN

ADDRESS: NO.2-4 WOODMERE AVENUE PARADISE

CLIENT: BARRIO DEVELOPMENTS

Residential
Commercial
Industrial

Consulting Engineers

1 Hawke Street
ALBERT PARK, SA 5014
P (08) 8241 2326
F (08) 8241 2409
admin@rciconsulting.com.au
www.rciconsulting.com.au

© This drawing is copyright to RCI Consulting Engineers, no part of this drawing shall be used for any other purpose nor by any other person without the written consent of RCI Consulting Engineers.

JOB No. F25595 SHEET No. 1 of 5 ISSUE No. A

DRAWN : L.F. DESIGN: D.A. DATE: 2-Jul-18

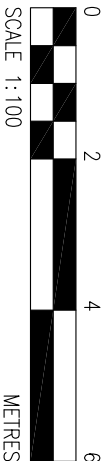

No.	REVISION	BY	DATE
A	SLABS SHORTENED AS REQUESTED	R.M.	06.09.19

LICATURES: W8 @ 1200mm CRS. WHERE FOOTING BEAM IS NOT FOUND IN NATURAL SOIL/CONTROLLED FILL PROVIDE LICATURES @ 300mm CRS.

SLAB: 100mm THICK SLAB REINFORCED WITH ONE LAYER OF SL72 TOP WITH 20mm COVER. WHERE THE DEPTH OF FILL BELOW THE SLAB PANELS EXCEEDS 400mm INCREASE SLAB DEPTH TO 125mm AND PLACE AN ADDITIONAL LAYER OF SL72 MESH BOTTOM WITH 30mm OF BOTTOM COVER. (REFER TO LEGEND). N20 CONCRETE UNLESS NOTED OTHERWISE. (FOR ALL JOBS LOCATED IN CORROSION ZONE, CONCRETE STRENGTH FOR EXTERNAL FOOTINGS (EXPOSED FACE) MUST BE N32 CONCRETE).

SOIL CLASSIFICATION: H1-N-D
- 20mm THICK CLOSED-CELL POLYETHYLENE LAGGING AROUND STORMWATER AND SEWER DRAIN PENETRATIONS THROUGH EXTERNAL FOOTINGS.
- FLEXIBLE CONNECTIONS IN SEWER & STORMWATER DRAIN ARE REQUIRED

GENERAL NOTES

- THIS DRAWING TO BE READ IN CONJUNCTION WITH THE FOOTING CONSTRUCTION REPORT AND ARCHITECTURAL DRAWINGS. IF ANY CONFLICT OCCURS CONTACT THIS OFFICE IMMEDIATELY.
- THIS FOOTING PLAN ASSUMES THE SITEMWORKS AND DRAINAGE ARE CARRIED OUT IN ACCORDANCE WITH THE FOOTING CONSTRUCTION REPORT.
- THESE DRAWING ARE NOT TO BE SCALED FROM. ALL WRITTEN DIMENSIONS ARE IN mm UNLESS NOTED OTHERWISE.
- ALL FOOTINGS TO BE FOUNDED A MINIMUM 100mm INTO NATURAL SOIL OR CONTROLLED FILL IF PRESENT (REFER TO BORELOS). FOOTING TO BE TRENCHED OR PIERED AS REQUIRED TO ENSURE 100mm MINIMUM FOUNDING.
- PIERS AND EXTENT OF THICKENED SLAB/DOUBLE MESH ARE SHOWN INDICATIVELY ONLY AND SHALL BE CONFIRMED ON SITE AT THE TIME OF A TRENCH INSPECTION.

A3

P1: 450mm SQUARE x 600mm DEEP MASS CONCRETE PAD FOOTING FOUNDED 100mm MIN INTO NATURAL SOIL OR CONTROLLED FILL. INCREASE PAD DEPTH IF/AS REQUIRED TO ACHIEVE THE ABOVE.

FOOTING BEAMS				
BEAM	WIDTH (mm)	DEPTH (mm)	REINFORCEMENT TOP SIZE No. BOTTOM SIZE No.	
B1	300	700	3 N16	3 N16
B2	350	700	3 N16	3 N16

BOREHOLE
(REFER TO BORELOG)

DEPTH OF FILL FOUND IN BOREHOLE				
HOLE 1	0mm	HOLE 9	0mm	
HOLE 2	0mm	HOLE 10	0mm	
HOLE 3	0mm	HOLE 11	0mm	
HOLE 4	0mm	HOLE 12	0mm	
HOLE 5	0mm	HOLE 13	0mm	
HOLE 6	0mm	HOLE 14	0mm	
HOLE 7	0mm	HOLE 15	0mm	
HOLE 8	0mm			

LEGEND

3/N12 x 2000mm LONG CRACK CONTROL BARS TIED TO UNDERSIDE OF TOP MESH.
STEP IN FOOTING BEAM, REFER TO FOOTING CONSTRUCTION REPORT FOR DETAILS.

1200mm LONG (MIN) x FOOTING WIDTH WIDE PIER, FOUND 100mm INTO NATURAL SOIL OR CONTROLLED FILL IF PRESENT (REFER TO BORELOGS). REINFORCE WITH 4/N12 RODS VERTICAL WHERE DEPTH BELOW BASE OF FOOTING EXCEEDS 400mm. EXTENT OF PIERS TO BE CONFIRMED ON SITE.

SET DOWN IN RAFT SLAB REFER TO FOOTING CONSTRUCTION REPORT FOR DETAILS. ENSURE FOOTING DEPTHS ARE MAINTAINED BELOW SET DOWN.

125mm THICK SLAB WITH TWO LAYERS OF MESH. ONE LAYER PLACED WITH 20mm TOP COVER AND THE OTHER WITH 30mm BOTTOM COVER. REFER TO SLAB NOTES FOR MESH SIZE. AREA SHOWN HATCHED IS INDICATIVE ONLY AND IS TO BE CONFIRMED ON SITE.

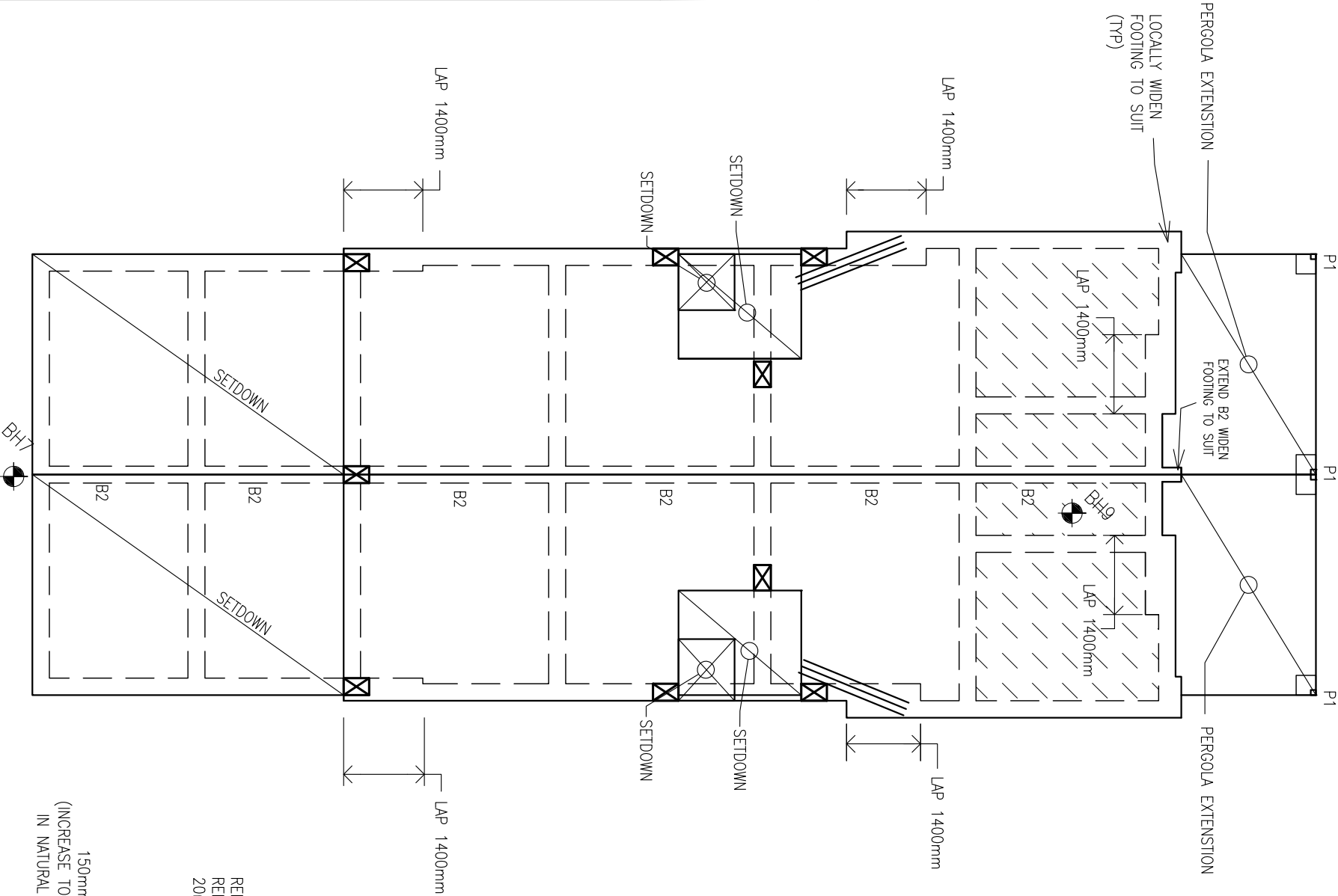

ALL FOOTING BEAMS ARE "B1" UNLESS NOTED OTHERWISE

WHERE BRITTLE FLOOR COVERINGS (eg TILED SURFACES) ARE TO BE USED OVER AN AREA GREATER THAN 16m² FLEXIBLE ADHESIVE IS TO BE USED BETWEEN THE FLOOR COVERING AND SLAB. APPLY IN ACCORDANCE TO MANUFACTURERS SPECIFICATION TO ALLOW FOR POSSIBLE CONCRETE SHRINKAGE.

IMPORTANT NOTE:

BUILDER MUST ENSURE THAT AN ALLOWANCE FOR ANY SERVICE TRENCHES ON THE FOUNDING LEVEL OF THE FOOTINGS AND ANY STORMWATER SLEEVES THROUGH FOOTINGS ARE PROVIDED. BASE OF FOOTINGS MUST BE FOUNDED 100mm INTO NATURAL SOIL OR CONTROLLED FILL AND SUCH THAT A 45 DEGREE LINE DRAWN FROM THE BOTTOM OF THE PIER DOES NOT INTERSECT THE ADJOINING SERVICE TRENCH EXCAVATION. WHERE THIS CANNOT BE ACHIEVED, PLEASE PROVIDE 1200mm LONG x FOOTING WIDTH WIDE PIERS (AT FOOTING BEAM JUNCTIONS PARALLEL TO EXTERNAL FOOTINGS) TO ENSURE ABOVE CONDITION IS ACHIEVED. WHERE THE PIER DEPTH MEASURED FROM THE BOTTOM OF THE FOOTING EXCEEDS 400mm REINFORCE WITH 4/N12 VERTICAL BARS.

IMPORTANT NOTE:

THIS FOOTING DESIGN IS BASED ON ALL STORMWATER (INCLUDING SURFACE STORMWATER) BE REMOVED FROM AROUND THE DWELLING IN ACCORDANCE WITH ASS500.3, AS2870 AND THE BCA. WHERE GRAVITY FLOW OF STORMWATER IN ACCORDANCE WITH ASS500.3 CAN NOT BE ACHIEVED TO THE WATERABLE OR DOWN SLOPE ON AN ACRAGE SITE A SUMP PUMP WILL BE REQUIRED. RCI CONSULTING ENGINEERS WILL TAKE NO RESPONSIBILITY FOR FOOTING MOVEMENT RESULTING FROM STORMWATER DRAINAGE FAILURE TO COMPLY TO THE ABOVE.

NOTE:

ALL B2 FOOTINGS REQUIRED TO BE CONSTRUCTED ON BOUNDARY ARE TO BE FOUNDED A MINIMUM 600mm BELOW THE EXISTING ALLOTMENT GROUND LEVEL.

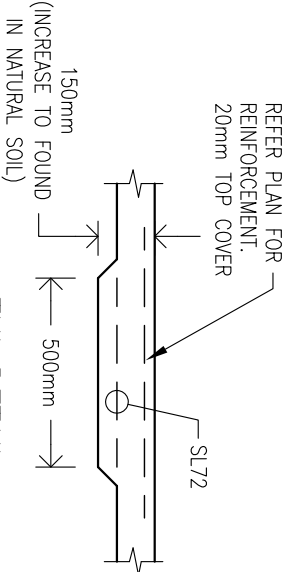

THI DETAIL
NOT TO SCALE

FOOTING PLAN

ADDRESS: NO.2-4 WOODMERE AVENUE PARADISE

CLIENT: BARRIO DEVELOPMENTS

Residential Commercial Industrial
1 Hawke Street
ALBERT PARK, SA 5014
P (08) 8241 2326
F (08) 8241 2409
admin@rciconsulting.com.au
www.rciconsulting.com.au

Consulting Engineers

© This drawing is copyright to RCI Consulting Engineers, no part of this drawing shall be used for any other purpose nor by any other person without the written consent of RCI Consulting Engineers.

A.B.N. 17 131 375 356

JOB No. F25595
SHEET No. 2 of 5
ISSUE No. A

DRAWN : L.F. DESIGN: D.A. DATE: 2-Jul-18

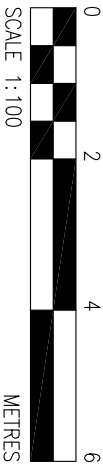

No.	REVISION	BY	DATE
A	SLABS SHORTENED AS REQUESTED	R.M.	06.09.19

LICATURES:
W8 @ 1200mm CRS. WHERE FOOTING BEAM IS NOT FOUND IN NATURAL SOIL/CONTROLLED FILL PROVIDE LICATURES @ 300mm CRS.

SLAB:
100mm THICK SLAB REINFORCED WITH ONE LAYER OF SL72 TOP WITH 20mm COVER. WHERE THE DEPTH OF FILL BELOW THE SLAB PANELS EXCEEDS 400mm INCREASE SLAB DEPTH TO 125mm AND PLACE AN ADDITIONAL LAYER OF SL72 MESH BOTTOM WITH 30mm OF BOTTOM COVER. (REFER TO LEGEND). N20 CONCRETE UNLESS NOTED OTHERWISE. (FOR ALL JOBS LOCATED IN CORROSION ZONE, CONCRETE STRENGTH FOR EXTERNAL FOOTINGS (EXPOSED FACE) MUST BE N32 CONCRETE).

SOIL CLASSIFICATION: H1-N-D
- 20mm THICK CLOSED-CELL POLYETHYLENE LAGGING AROUND STORMWATER AND SEWER DRAIN PENETRATIONS THROUGH EXTERNAL FOOTINGS.
- FLEXIBLE CONNECTIONS IN SEWER & STORMWATER DRAIN ARE REQUIRED

GENERAL NOTES

- THIS DRAWING TO BE READ IN CONJUNCTION WITH THE FOOTING CONSTRUCTION REPORT AND ARCHITECTURAL DRAWINGS. IF ANY CONFLICT OCCURS CONTACT THIS OFFICE IMMEDIATELY.
- THIS FOOTING PLAN ASSUMES THE SITEMARKS AND DRAINAGE ARE CARRIED OUT IN ACCORDANCE WITH THE FOOTING CONSTRUCTION REPORT.
- THESE DRAWING ARE NOT TO BE SCALED FROM. ALL WRITTEN DIMENSIONS ARE IN mm UNLESS NOTED OTHERWISE.
- ALL FOOTINGS TO BE FOUNDED A MINIMUM 100mm INTO NATURAL SOIL OR CONTROLLED FILL IF PRESENT (REFER TO BORELOGS). FOOTING TO BE TRENCHED OR PIERED AS REQUIRED TO ENSURE 100mm MINIMUM FOUNDING.
- PIERS AND EXTENT OF THICKENED SLAB/DOUBLE MESH ARE SHOWN INDICATIVELY ONLY AND SHALL BE CONFIRMED ON SITE AT THE TIME OF A TRENCH INSPECTION.

A3

P1: 450mm SQUARE x 600mm DEEP MASS CONCRETE PAD FOOTING FOUNDED 100mm MIN INTO NATURAL SOIL OR CONTROLLED FILL. INCREASE PAD DEPTH IF/AS REQUIRED TO ACHIEVE THE ABOVE.

FOOTING BEAMS				
BEAM	WIDTH (mm)	DEPTH (mm)	REINFORCEMENT TOP SIZE No.	BOTTOM SIZE No.
B1	300	700	3 N16	3 N16
B2	350	700	3 N16	3 N16

BOREHOLE
(REFER TO BORELOG)

DEPTH OF FILL FOUND IN BOREHOLE				
HOLE 1	0mm	HOLE 9	0mm	
HOLE 2	0mm	HOLE 10	0mm	
HOLE 3	0mm	HOLE 11	0mm	
HOLE 4	0mm	HOLE 12	0mm	
HOLE 5	0mm	HOLE 13	0mm	
HOLE 6	0mm	HOLE 14	0mm	
HOLE 7	0mm	HOLE 15	0mm	
HOLE 8	0mm			

LEGEND

3/N12 x 2000mm LONG CRACK CONTROL BARS TIED TO UNDERSIDE OF TOP MESH.
STEP IN FOOTING BEAM, REFER TO FOOTING CONSTRUCTION REPORT FOR DETAILS.

1200mm LONG (MIN) x FOOTING WIDTH WIDE PIER, FOUND 100mm INTO NATURAL SOIL OR CONTROLLED FILL IF PRESENT (REFER TO BORELOGS). REINFORCE WITH 4/N12 RODS VERTICAL WHERE DEPTH BELOW BASE OF FOOTING EXCEEDS 400mm. EXTENT OF PIERS TO BE CONFIRMED ON SITE.

SET DOWN IN RAFT SLAB REFER TO FOOTING CONSTRUCTION REPORT FOR DETAILS. ENSURE FOOTING DEPTHS ARE MAINTAINED BELOW SET DOWN.

125mm THICK SLAB WITH TWO LAYERS OF MESH. ONE LAYER PLACED WITH 20mm TOP COVER AND THE OTHER WITH 30mm BOTTOM COVER. REFER TO SLAB NOTES FOR MESH SIZE. AREA SHOWN HATCHED IS INDICATIVE ONLY AND IS TO BE CONFIRMED ON SITE.

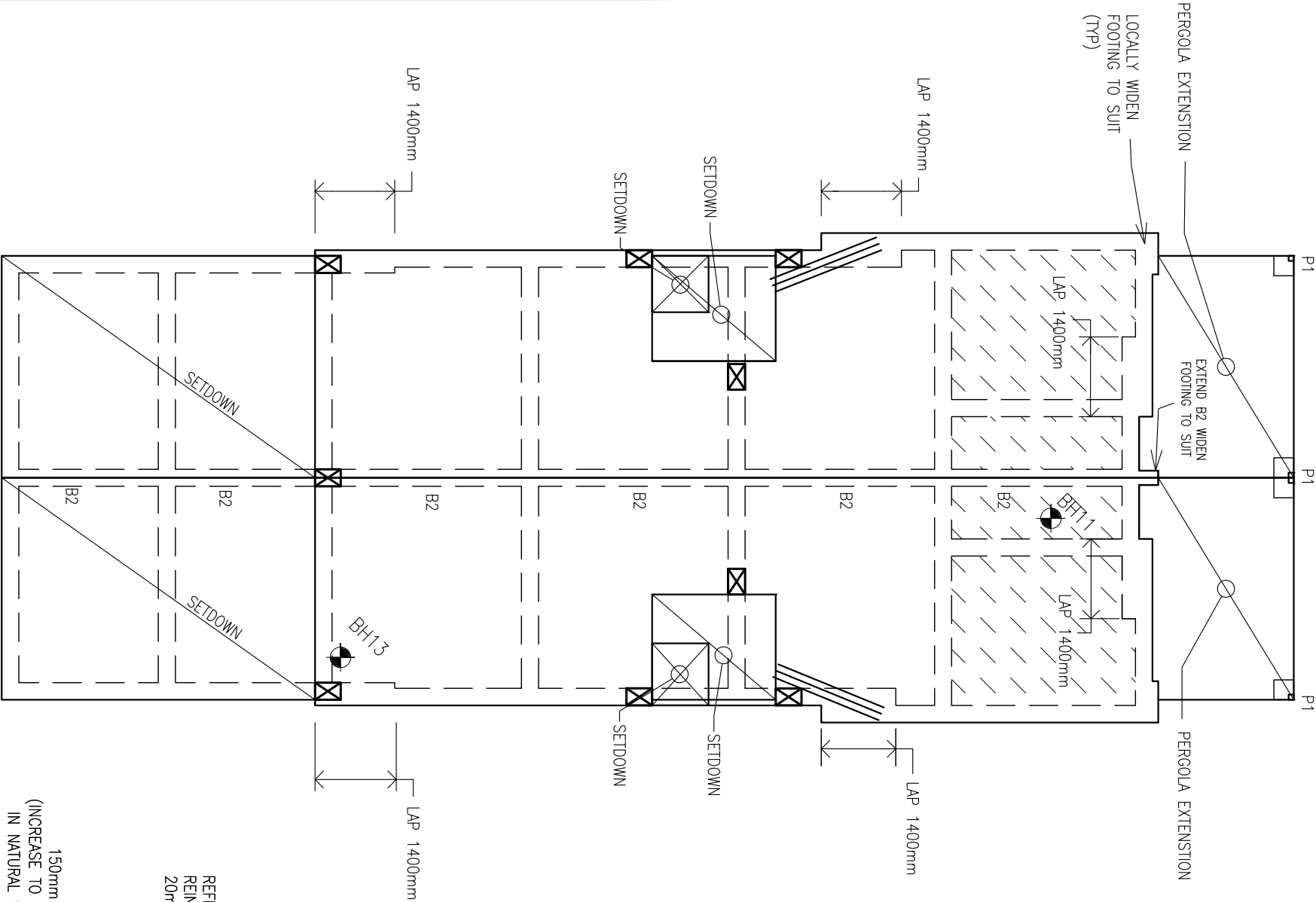

WHERE BRITTLE FLOOR COVERINGS (eg TILED SURFACES) ARE TO BE USED OVER AN AREA GREATER THAN 16m² FLEXIBLE ADHESIVE IS TO BE USED BETWEEN THE FLOOR COVERING AND SLAB. APPLY IN ACCORDANCE TO MANUFACTURERS SPECIFICATION TO ALLOW FOR POSSIBLE CONCRETE SHRINKAGE.

ALL FOOTING BEAMS ARE "B1" UNLESS NOTED OTHERWISE

IMPORTANT NOTE:

BUILDER MUST ENSURE THAT AN ALLOWANCE FOR ANY SERVICE TRENCHES ON THE FOUNDING LEVEL OF THE FOOTINGS AND ANY STORMWATER SLEEVES THROUGH FOOTINGS ARE PROVIDED. BASE OF FOOTINGS MUST BE FOUNDED 100mm INTO NATURAL SOIL OR CONTROLLED FILL AND SUCH THAT A 45 DEGREE LINE DRAWN FROM THE BOTTOM OF THE PIER DOES NOT INTERSECT THE ADJOINING SERVICE TRENCH EXCAVATION. WHERE THIS CANNOT BE ACHIEVED, PLEASE PROVIDE 1200mm LONG x FOOTING WIDTH WIDE PIERS (AT FOOTING BEAM JUNCTIONS PARALLEL TO EXTERNAL FOOTINGS) TO ENSURE ABOVE CONDITION IS ACHIEVED. WHERE THE PIER DEPTH MEASURED FROM THE BOTTOM OF THE FOOTING EXCEEDS 400mm REINFORCE WITH 4/N12 VERTICAL BARS.

IMPORTANT NOTE:

THIS FOOTING DESIGN IS BASED ON ALL STORMWATER (INCLUDING SURFACE STORMWATER) BE REMOVED FROM AROUND THE DWELLING IN ACCORDANCE WITH ASS500.3, AS2870 AND THE BCA. WHERE GRAVITY FLOW OF STORMWATER IN ACCORDANCE WITH ASS500.3 CAN NOT BE ACHIEVED TO THE WATERABLE OR DOWN SLOPE ON AN AGERAGE SITE A SUMP PUMP WILL BE REQUIRED. RCI CONSULTING ENGINEERS WILL TAKE NO RESPONSIBILITY FOR FOOTING MOVEMENT RESULTING FROM STORMWATER DRAINAGE FAILURE TO COMPLY TO THE ABOVE.

NOTE:

ALL B2 FOOTINGS REQUIRED TO BE CONSTRUCTED ON BOUNDARY ARE TO BE FOUNDED A MINIMUM 600mm BELOW THE EXISTING ALLOTMENT GROUND LEVEL.

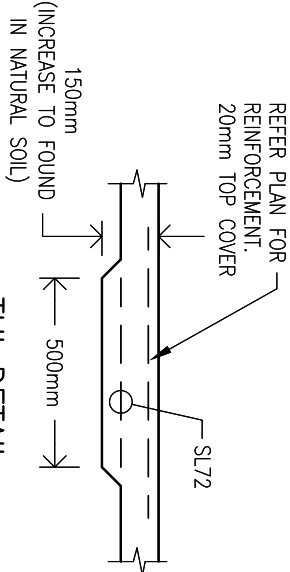

THI DETAIL
NOT TO SCALE

FOOTING PLAN

ADDRESS: NO.2-4 WOODMERE AVENUE
PARADISE

CLIENT: BARRIO DEVELOPMENTS

Residential
Commercial
Industrial

Consulting Engineers

1 Hawke Street
ALBERT PARK, SA 5014
P (08) 8241 2326
F (08) 8241 2409
admin@rciconsulting.com.au
www.rciconsulting.com.au

© This drawing is copyright to RCI Consulting Engineers, no part of this drawing shall be used for any other purpose nor by any other person without the written consent of RCI Consulting Engineers.

JOB No.
F25595

SHEET No.
3 of 5

ISSUE No.
A

DRAWN : L.F.

DESIGN: D.A.

DATE: 2-Jul-18

No.

A	SLABS SHORTENED AS REQUESTED	BY	R.M.	DATE	06.09.19
---	------------------------------	----	------	------	----------

LICATURES:
WB @ 1200mm CRS. WHERE FOOTING BEAM IS NOT FOUND IN NATURAL SOIL/CONTROLLED FILL PROVIDE LICATURES @ 300mm CRS.

SLAB:
100mm THICK SLAB REINFORCED WITH ONE LAYER OF SL72 TOP WITH 20mm COVER. WHERE THE DEPTH OF FILL BELOW THE SLAB PANELS EXCEEDS 400mm INCREASE SLAB DEPTH TO 125mm AND PLACE AN ADDITIONAL LAYER OF SL72 MESH BOTTOM WITH 30mm OF BOTTOM COVER. (REFER TO LEGEND). N20 CONCRETE UNLESS NOTED OTHERWISE. (FOR ALL JOBS LOCATED IN CORROSION ZONE, CONCRETE STRENGTH FOR EXTERNAL FOOTINGS (EXPOSED FACE) MUST BE N32 CONCRETE).

SOIL CLASSIFICATION: H1-D
- 20mm THICK CLOSED-CELL POLYETHYLENE LAGGING AROUND STORMWATER AND SEWER DRAIN PENETRATIONS THROUGH EXTERNAL FOOTINGS.
- FLEXIBLE CONNECTIONS IN SEWER & STORMWATER DRAIN ARE REQUIRED

GENERAL NOTES

- THIS DRAWING TO BE READ IN CONJUNCTION WITH THE FOOTING CONSTRUCTION REPORT AND ARCHITECTURAL DRAWINGS. IF ANY CONFLICT OCCURS CONTACT THIS OFFICE IMMEDIATELY.
- THIS FOOTING PLAN ASSUMES THE SITEMWORKS AND DRAINAGE ARE CARRIED OUT IN ACCORDANCE WITH THE FOOTING CONSTRUCTION REPORT.
- THESE DRAWING ARE NOT TO BE SCALED FROM. ALL WRITTEN DIMENSIONS ARE IN mm UNLESS NOTED OTHERWISE.
- ALL FOOTINGS TO BE FOUNDED A MINIMUM 100mm INTO NATURAL SOIL OR CONTROLLED FILL IF PRESENT (REFER TO BORELOGS). FOOTING TO BE TRENCHED OR PIERED AS REQUIRED TO ENSURE 100mm MINIMUM FOUNDING.
- PIERS AND EXTENT OF THICKENED SLAB/DOUBLE MESH ARE SHOWN INDICATIVELY ONLY AND SHALL BE CONFIRMED ON SITE AT THE TIME OF A TRENCH INSPECTION.

A3

P1: 450mm SQUARE x 600mm DEEP MASS CONCRETE PAD FOOTING FOUNDED 100mm MIN INTO NATURAL SOIL OR CONTROLLED FILL. INCREASE PAD DEPTH IF/AS REQUIRED TO ACHIEVE THE ABOVE.

FOOTING BEAMS				
BEAM	WIDTH (mm)	DEPTH (mm)	REINFORCEMENT TOP SIZE No.	BOTTOM SIZE No.
B1	300	700	3 N16	3 N16
B2	350	700	3 N16	3 N16

BOREHOLE
(REFER TO BORELOG)

DEPTH OF FILL FOUND IN BOREHOLE				
HOLE 1	0mm	HOLE 9	0mm	
HOLE 2	0mm	HOLE 10	0mm	
HOLE 3	0mm	HOLE 11	0mm	
HOLE 4	0mm	HOLE 12	0mm	
HOLE 5	0mm	HOLE 13	0mm	
HOLE 6	0mm	HOLE 14	0mm	
HOLE 7	0mm	HOLE 15	0mm	
HOLE 8	0mm			

LEGEND

3/N12 x 2000mm LONG CRACK CONTROL BARS TIED TO UNDERSIDE OF TOP MESH.
STEP IN FOOTING BEAM, REFER TO FOOTING CONSTRUCTION REPORT FOR DETAILS.

1200mm LONG (MIN) x FOOTING WIDTH WIDE PIER, FOUND 100mm INTO NATURAL SOIL OR CONTROLLED FILL IF PRESENT (REFER TO BORELOGS). REINFORCE WITH 4/N12 RODS VERTICAL WHERE DEPTH BELOW BASE OF FOOTING EXCEEDS 400mm. EXTENT OF PIERS TO BE CONFIRMED ON SITE.

SET DOWN IN RAFT SLAB REFER TO FOOTING CONSTRUCTION REPORT FOR DETAILS. ENSURE FOOTING DEPTHS ARE MAINTAINED BELOW SET DOWN.

125mm THICK SLAB WITH TWO LAYERS OF MESH. ONE LAYER PLACED WITH 20mm TOP COVER AND THE OTHER WITH 30mm BOTTOM COVER. REFER TO SLAB NOTES FOR MESH SIZE. AREA SHOWN HATCHED IS INDICATIVE ONLY AND IS TO BE CONFIRMED ON SITE.

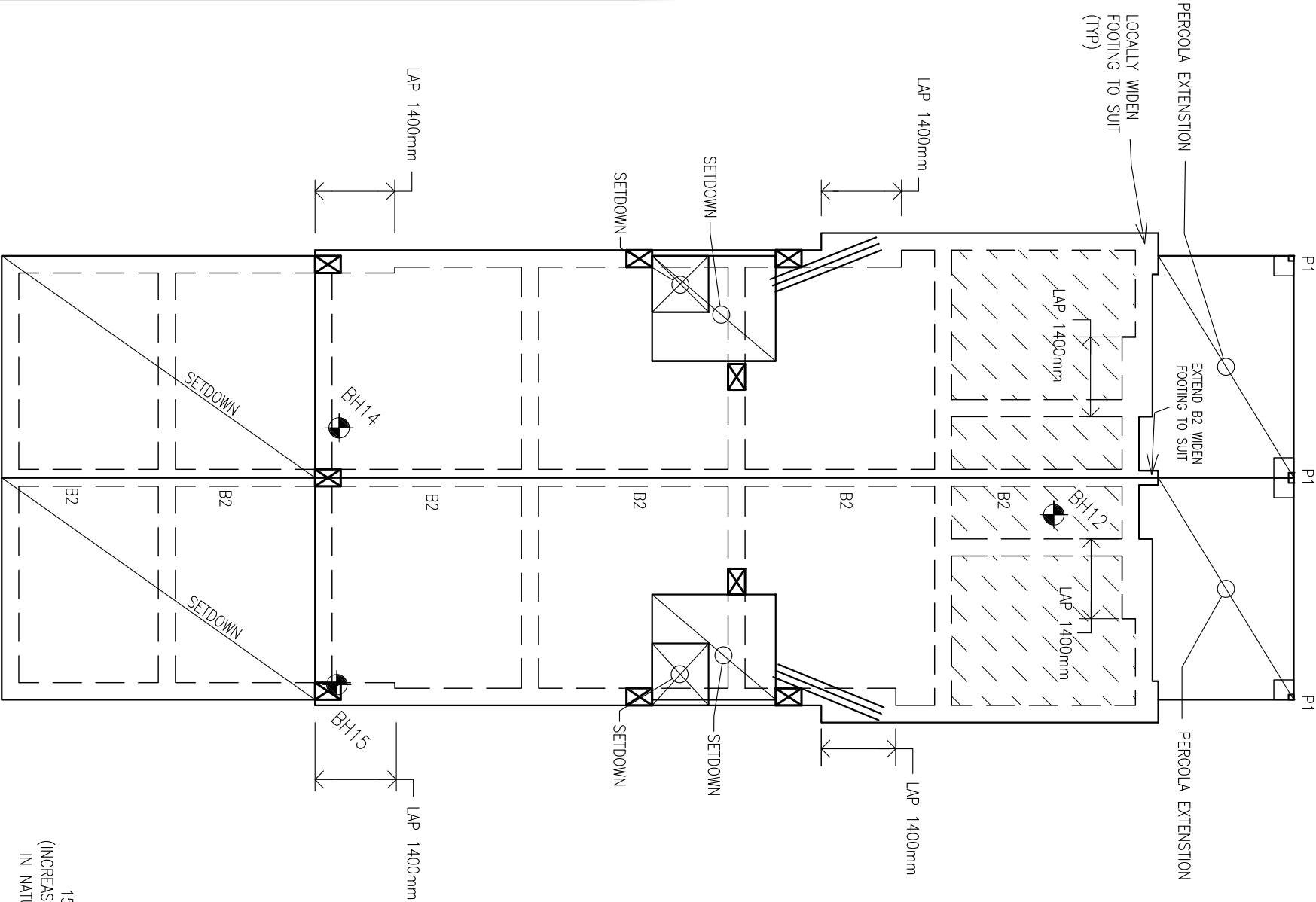

WHERE BRITTLE FLOOR COVERINGS (eg TILED SURFACES) ARE TO BE USED OVER AN AREA GREATER THAN 16m² FLEXIBLE ADHESIVE IS TO BE USED BETWEEN THE FLOOR COVERING AND SLAB. APPLY IN ACCORDANCE TO MANUFACTURERS SPECIFICATION TO ALLOW FOR POSSIBLE CONCRETE SHRINKAGE.

ALL FOOTING BEAMS ARE "B1" UNLESS NOTED OTHERWISE

IMPORTANT NOTE:

BUILDER MUST ENSURE THAT AN ALLOWANCE FOR ANY SERVICE TRENCHES ON THE FOUNDING LEVEL OF THE FOOTINGS AND ANY STORMWATER SLEEVES THROUGH FOOTINGS ARE PROVIDED. BASE OF FOOTINGS MUST BE FOUNDED 100mm INTO NATURAL SOIL OR CONTROLLED FILL AND SUCH THAT A 45 DEGREE LINE DRAWN FROM THE BOTTOM OF THE PIER DOES NOT INTERSECT THE ADJOINING SERVICE TRENCH EXCAVATION. WHERE THIS CANNOT BE ACHIEVED, PLEASE PROVIDE 1200mm LONG x FOOTING WIDTH WIDE PIERS (AT FOOTING BEAM JUNCTIONS PARALLEL TO EXTERNAL FOOTINGS) TO ENSURE ABOVE CONDITION IS ACHIEVED. WHERE THE PIER DEPTH MEASURED FROM THE BOTTOM OF THE FOOTING EXCEEDS 400mm REINFORCE WITH 4/N12 VERTICAL BARS.

IMPORTANT NOTE:

THIS FOOTING DESIGN IS BASED ON ALL STORMWATER (INCLUDING SURFACE STORMWATER) BE REMOVED FROM AROUND THE DWELLING IN ACCORDANCE WITH ASS500.3, AS2870 AND THE BCA. WHERE GRAVITY FLOW OF STORMWATER IN ACCORDANCE WITH ASS500.3 CAN NOT BE ACHIEVED TO THE WATERABLE OR DOWN SLOPE ON AN ACRAGE SITE A SUMP PUMP WILL BE REQUIRED. RCI CONSULTING ENGINEERS WILL TAKE NO RESPONSIBILITY FOR FOOTING MOVEMENT RESULTING FROM STORMWATER DRAINAGE FAILURE TO COMPLY TO THE ABOVE.

NOTE:

ALL B2 FOOTINGS REQUIRED TO BE CONSTRUCTED ON BOUNDARY ARE TO BE FOUNDED A MINIMUM 600mm BELOW THE EXISTING ALLOTMENT GROUND LEVEL.

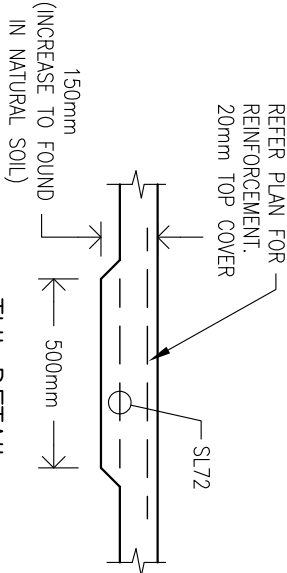

THI DETAIL
NOT TO SCALE

FOOTING PLAN

ADDRESS: NO.2-4 WOODMERE AVENUE
PARADISE

CLIENT: BARRIO DEVELOPMENTS

Residential
Commercial
Industrial

Consulting Engineers

1 Hawke Street
ALBERT PARK, SA 5014
P (08) 8241 2326
F (08) 8241 2409
admin@rciconsulting.com.au
www.rciconsulting.com.au

© This drawing is copyright to RCI Consulting Engineers, no part of this drawing shall be used for any other purpose nor by any other person without the written consent of RCI Consulting Engineers.

JOB No. **F25595** SHEET No. 4 of 5 ISSUE No. **A**

DRAWN : L.F. DESIGN: D.A. DATE: 2-Jul-18

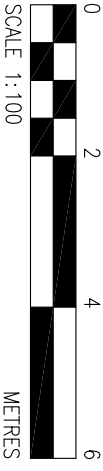

No.	REVISION	BY	DATE
A.	SLABS SHORTENED AS REQUESTED	R.M.	06.09.19

LICATURES:
W8 @ 1200mm CRS. WHERE FOOTING BEAM IS NOT FOUND IN NATURAL SOIL/CONTROLLED FILL PROVIDE LICATURES @ 300mm CRS.

SLAB:
100mm THICK SLAB REINFORCED WITH ONE LAYER OF SL72 TOP WITH 20mm COVER. WHERE THE DEPTH OF FILL BELOW THE SLAB PANELS EXCEEDS 400mm INCREASE SLAB DEPTH TO 125mm AND PLACE AN ADDITIONAL LAYER OF SL72 MESH BOTTOM WITH 30mm OF BOTTOM COVER. (REFER TO LEGEND). N20 CONCRETE UNLESS NOTED OTHERWISE. (FOR ALL JOBS LOCATED IN CORROSION ZONE, CONCRETE STRENGTH FOR EXTERNAL FOOTINGS (EXPOSED FACE) MUST BE N32 CONCRETE).

SOIL CLASSIFICATION: **H1-N-D**
- 20mm THICK CLOSED-CELL POLYETHYLENE LAGGING AROUND STORMWATER AND SEWER DRAIN PENETRATIONS THROUGH EXTERNAL FOOTINGS.
- FLEXIBLE CONNECTIONS IN SEWER & STORMWATER DRAIN ARE REQUIRED

GENERAL NOTES

- THIS DRAWING TO BE READ IN CONJUNCTION WITH THE FOOTING CONSTRUCTION REPORT AND ARCHITECTURAL DRAWINGS. IF ANY CONFLICT OCCURS CONTACT THIS OFFICE IMMEDIATELY.
- THIS FOOTING PLAN ASSUMES THE SITEWORKS AND DRAINAGE ARE CARRIED OUT IN ACCORDANCE WITH THE FOOTING CONSTRUCTION REPORT.
- THESE DRAWING ARE NOT TO BE SCALED FROM. ALL WRITTEN DIMENSIONS ARE IN mm UNLESS NOTED OTHERWISE.
- ALL FOOTINGS TO BE FOUNDED A MINIMUM 100mm INTO NATURAL SOIL OR CONTROLLED FILL IF PRESENT (REFER TO BORELOGS). FOOTING TO BE TRENCHED OR PIERED AS REQUIRED TO ENSURE 100mm MINIMUM FOUNDING.
- PIERS AND EXTENT OF THICKENED SLAB/DOUBLE MESH ARE SHOWN INDICATIVELY ONLY AND SHALL BE CONFIRMED ON SITE AT THE TIME OF A TRENCH INSPECTION.

A3

P1: 450mm SQUARE x 600mm DEEP MASS CONCRETE PAD FOOTING FOUNDED 100mm MIN INTO NATURAL SOIL OR CONTROLLED FILL. INCREASE PAD DEPTH IF/AS REQUIRED TO ACHIEVE THE ABOVE.

FOOTING BEAMS				
BEAM	WIDTH (mm)	DEPTH (mm)	REINFORCEMENT TOP SIZE No.	BOTTOM SIZE No.
B1	300	700	3 N16	3 N16
B2	350	700	3 N16	3 N16

BOREHOLE
(REFER TO BORELOGS)

DEPTH OF FILL FOUND IN BOREHOLE				
HOLE 1	0mm	HOLE 9	0mm	
HOLE 2	0mm	HOLE 10	0mm	
HOLE 3	0mm	HOLE 11	0mm	
HOLE 4	0mm	HOLE 12	0mm	
HOLE 5	0mm	HOLE 13	0mm	
HOLE 6	0mm	HOLE 14	0mm	
HOLE 7	0mm	HOLE 15	0mm	
HOLE 8	0mm			

LEGEND

- 3/N12 x 2000mm LONG CRACK CONTROL BARS TIED TO UNDERSIDE OF TOP MESH.
- STEP IN FOOTING BEAM, REFER TO FOOTING CONSTRUCTION REPORT FOR DETAILS.
- 1200mm LONG (MIN) x FOOTING WIDTH WIDE PIER, FOUND 100mm INTO NATURAL SOIL OR CONTROLLED FILL IF PRESENT (REFER TO BORELOGS). REINFORCE WITH 4/N12 RODS VERTICAL WHERE DEPTH BELOW BASE OF FOOTING EXCEEDS 400mm. EXTENT OF PIERS TO BE CONFIRMED ON SITE.

SET DOWN IN RAFT SLAB REFER TO FOOTING CONSTRUCTION REPORT FOR DETAILS. ENSURE FOOTING DEPTHS ARE MAINTAINED BELOW SET DOWN.

- 125mm THICK SLAB WITH TWO LAYERS OF MESH. ONE LAYER PLACED WITH 20mm TOP COVER AND THE OTHER WITH 30mm BOTTOM COVER. REFER TO SLAB NOTES FOR MESH SIZE. AREA SHOWN HATCHED IS INDICATIVE ONLY AND IS TO BE CONFIRMED ON SITE.

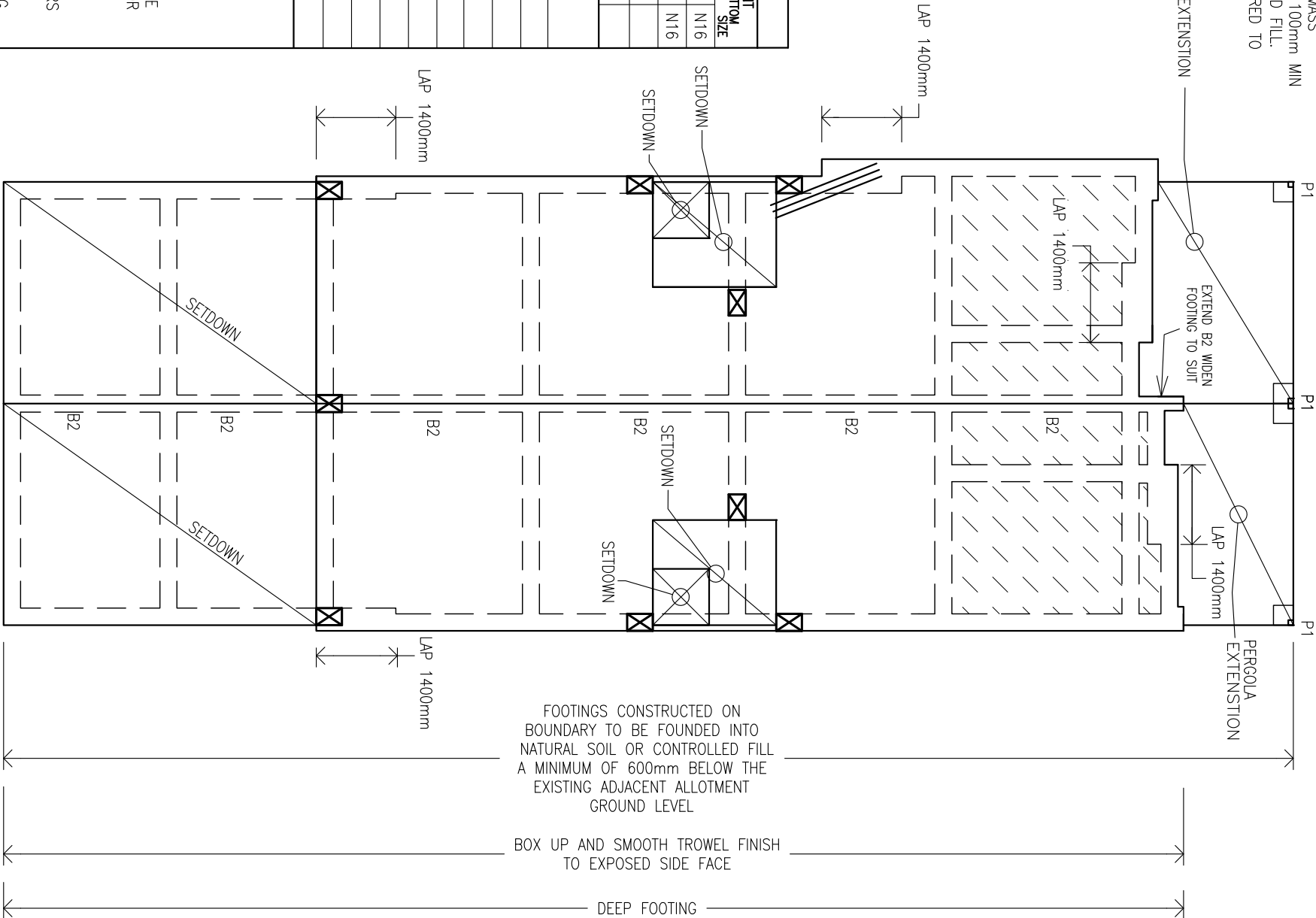

ALL FOOTING BEAMS ARE "B1" UNLESS NOTED OTHERWISE.

WHERE BRITTLE FLOOR COVERINGS (eg TILED SURFACES) ARE TO BE USED OVER AN AREA GREATER THAN 16m² FLEXIBLE ADHESIVE IS TO BE USED BETWEEN THE FLOOR COVERING AND SLAB. APPLY IN ACCORDANCE TO MANUFACTURERS SPECIFICATION TO ALLOW FOR POSSIBLE CONCRETE SHRINKAGE.

IMPORTANT NOTE:

BUILDER MUST ENSURE THAT AN ALLOWANCE FOR ANY SERVICE TRENCHES ON THE FOUNDING LEVEL OF THE FOOTINGS AND ANY STORMWATER SLEEVES THROUGH FOOTINGS ARE PROVIDED. BASE OF FOOTINGS MUST BE FOUNDED 100mm INTO NATURAL SOIL OR CONTROLLED FILL AND SUCH THAT A 45 DEGREE LINE DRAWN FROM THE BOTTOM OF THE PIER DOES NOT INTERSECT THE ADJOINING SERVICE TRENCH EXCAVATION. WHERE THIS CANNOT BE ACHIEVED, PLEASE PROVIDE 1200mm LONG x FOOTING WIDTH WIDE PIERS (AT FOOTING BEAM JUNCTIONS PARALLEL TO EXTERNAL FOOTINGS) TO ENSURE ABOVE CONDITION IS ACHIEVED. WHERE THE PIER DEPTH MEASURED FROM THE BOTTOM OF THE FOOTING EXCEEDS 400mm REINFORCE WITH 4/N12 VERTICAL BARS.

IMPORTANT NOTE:

THIS FOOTING DESIGN IS BASED ON ALL STORMWATER (INCLUDING SURFACE STORMWATER) BE REMOVED FROM AROUND THE DWELLING IN ACCORDANCE WITH AS3500.3, AS2870 AND THE BCA. WHERE GRAVITY FLOW OF STORMWATER IN ACCORDANCE WITH AS3500.3 CAN NOT BE ACHIEVED TO THE WATERABLE OR DOWN SLOPE ON AN ACERAGE SITE A SUMP PUMP WILL BE REQUIRED. RCI CONSULTING ENGINEERS WILL TAKE NO RESPONSIBILITY FOR FOOTING MOVEMENT RESULTING FROM STORMWATER DRAINAGE FAILURE TO COMPLY TO THE ABOVE.

NOTE:

ALL B2 FOOTINGS REQUIRED TO BE CONSTRUCTED ON BOUNDARY ARE TO BE FOUNDED A MINIMUM 600mm BELOW THE EXISTING ALLOTMENT GROUND LEVEL.

REFER PLAN FOR REINFORCEMENT. 20mm TOP COVER

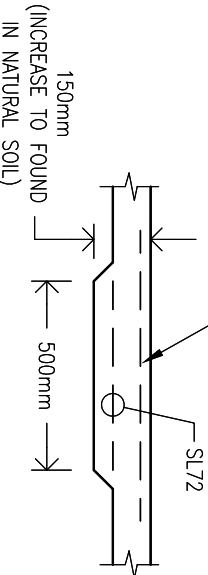

FOOTING PLAN

ADDRESS: NO.2-4 WOODMERE AVENUE PARADISE

CLIENT: BARRIO DEVELOPMENTS

Residential Commercial Industrial
Consulting Engineers
A.B.N. 17 131 375 356

1 Hawke Street
ALBERT PARK, SA 5014
P (08) 8241 2326
F (08) 8241 2409
admin@rciconsulting.com.au
www.rciconsulting.com.au

© The drawing is copyright to RCI Consulting Engineers, no part of this drawing shall be used for any other purpose nor by any other person without the written consent of RCI Consulting Engineers.

JOB No. **F25595** SHEET No. 5 of 5 ISSUE No. **A**

DRAWN : L.F. DESIGN: D.A. DATE: 2-Jul-18

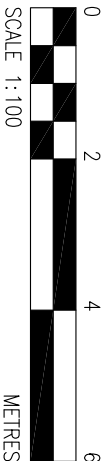

No.	REVISION	BY	DATE
A.	SLABS SHORTENED AS REQUESTED	R.M.	06.09.19

LICATURES: W8 @ 1200mm CRS. WHERE FOOTING BEAM IS NOT FOUND IN NATURAL SOIL/CONTROLLED FILL PROVIDE LICATURES @ 300mm CRS.

SLAB: 100mm THICK SLAB REINFORCED WITH ONE LAYER OF SL72 TOP WITH 20mm COVER. WHERE THE DEPTH OF FILL BELOW THE SLAB PANELS EXCEEDS 400mm INCREASE SLAB DEPTH TO 125mm AND PLACE AN ADDITIONAL LAYER OF SL72 MESH BOTTOM WITH 30mm OF BOTTOM COVER. (REFER TO LEGEND). N20 CONCRETE UNLESS NOTED OTHERWISE. (FOR ALL JOBS LOCATED IN CORROSION ZONE, CONCRETE STRENGTH FOR EXTERNAL FOOTINGS (EXPOSED FACE) MUST BE N32 CONCRETE).

SOIL CLASSIFICATION: H1~D
- 20mm THICK CLOSED-CELL POLYETHYLENE LAGGING AROUND STORMWATER AND SEWER DRAIN PENETRATIONS THROUGH EXTERNAL FOOTINGS.
- FLEXIBLE CONNECTIONS IN SEWER & STORMWATER DRAIN ARE REQUIRED

GENERAL NOTES

- THIS DRAWING TO BE READ IN CONJUNCTION WITH THE FOOTING CONSTRUCTION REPORT AND ARCHITECTURAL DRAWINGS. IF ANY CONFLICT OCCURS CONTACT THIS OFFICE IMMEDIATELY.
- THIS FOOTING PLAN ASSUMES THE SITEMWORKS AND DRAINAGE ARE CARRIED OUT IN ACCORDANCE WITH THE FOOTING CONSTRUCTION REPORT.
- THESE DRAWING ARE NOT TO BE SCALED FROM. ALL WRITTEN DIMENSIONS ARE IN mm UNLESS NOTED OTHERWISE.
- ALL FOOTINGS TO BE FOUNDED A MINIMUM 100mm INTO NATURAL SOIL OR CONTROLLED FILL IF PRESENT (REFER TO BORELOGS). FOOTING TO BE TRENCHED OR PIERED AS REQUIRED TO ENSURE 100mm MINIMUM FOUNDING.
- PIERS AND EXTENT OF THICKENED SLAB/DOUBLE MESH ARE SHOWN INDICATIVELY ONLY AND SHALL BE CONFIRMED ON SITE AT THE TIME OF A TRENCH INSPECTION.